

## TT-3060B The Capsat® Mobile Telephone

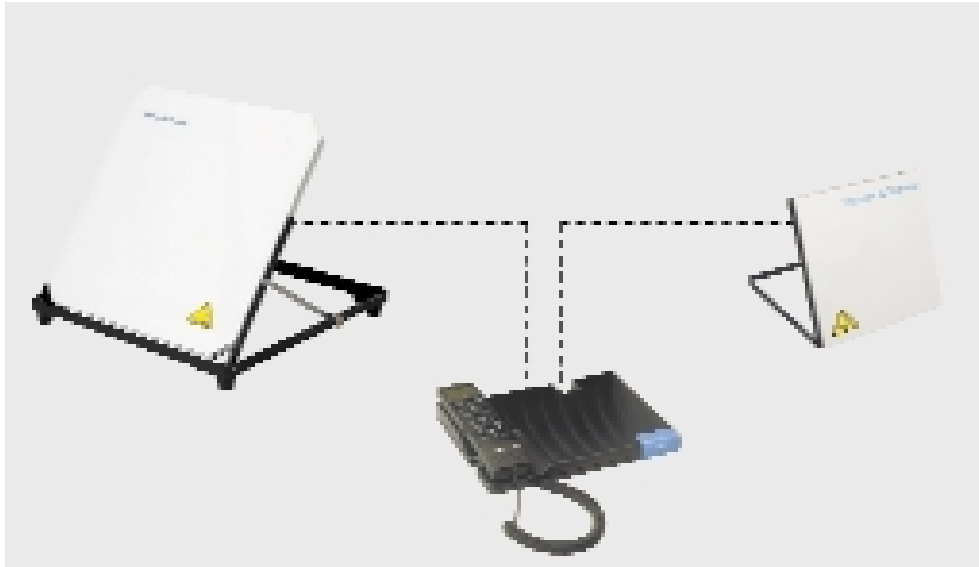

### Features

- Reliable and lightweight satellite telephone for worldwide transfer of your telephone calls, fax prints and data/e-mail messages.
- The Mini-M hybrid allows you to use the same transceiver with our portable and fixed antenna,
- The antennas have acoustic signal strength indicator for easy positioning.
- Handset, fax/2-wire RJ-11 phone port and Hayes comp. 2.4 kbps data port each with their own call ID (4 in total).
- Secure and tailored operation via built-in SIM card reader.
- Optional STU-IIB/STU-III.

### Description

The TT-3060B Capsat® Mobile Telephone gives you true independence and global connection to any destination in the world.

It handles both high quality telephone calls, fax prints, data transfers or e-mail messages.

You have the possibility of using the same transceiver with our portable and big dish antenna.

The transceiver is operated from the handset just like a normal GSM telephone. From the 2-wire DTMF phone interface a fax machine can be connected. For data you have the data port with the Hayes AT command sets.

The portable antenna is a small and discrete flat panel antenna, which is sealed for true outdoor operation. Together with the transceiver this unit weighs a mere 2.2 kg.

It is your very best choice for any mobile requirement in remote areas whether you are a travelling businessman or within rescue activities, news gathering, construction etc.

The big dish antenna is the perfect solution if you are at a stationary location. It is a fully sealed antenna and it can be mounted outdoors in the harshest weather conditions.

Due to the high gain antenna technology you can utilize the low call rates available when using this antenna.

The Big Dish system is the ideal system for rural public pay phones as it features various call restrictive functions.

The portable and the fixed antenna can be positioned up to 200 meters from the transceiver unit.

## Specifications

**General Specifications:** Inmarsat-phone spot-beam operation. Meets or exceeds current and proposed specifications.

**Operating Frequencies:** Receive 1525.0-1559.0 MHz, Transmit 1626.5-1660.5 MHz.

**Channel Spacing:** 1.25 kHz.

**Rx Modulation:** 5.6 kbps O-QPSK SCPC (voice/fax/data), 6 kbps BPSK TDMA.

**Tx Modulation:** 5.6 kbps O-QPSK SCPC (voice/fax/data), 3 kbps BPSK TDMA.

**Voice:** 4.8 kbps AMBE 3.6 kbps voice, 1.2 kbps FEC.

**Async. Data Rate:** Max 2.4 kbps.

**Phone Interface:** 2-wire 600( CCITT Rec. G.473, standard DTMF

telephones, RJ-11 jack.

**Fax Interface:** 2-wire 600 ohm CCITT

Rec. G.473, T.30 Group-III Fax, max. 2.4 kbps, RJ-11 jack.

**Data Interface:** Serial EIA standard RS-232E Hayes compatible, max. 19.2 kbps, DB-9 female connector.

**Printer Interface:** Serial EIA standard RS-232E, max. 19.2 kbps, DB-9 female connector.

**SIM Card:** GSM like operation. ISO-7816.

**Power Supply:** 10.5-18.5Vdc, typical 380mW

listen mode, 8W talk mode, 20W in fax/data mode.

**Spray(EME):** Solid droplets from any direction.

**Icing(EME):** Up to 25mm of ice (no operation).

**Rain(EME):** Up to 50mm hour.

**Wind(EME):** Relatively 200km/h (normal operation).

**Solar Panel Interface:** 15-25V dc input.

**Battery Capacity:** Typical listen time 48 hours, typical talk time 150 min. and fax/data time 55 min.

**Fast charge AC Adapter:** 90-265 Vac, 40-70 Hz, 55W, charge time approx. 2 hours.

**Ambient temperature:** -25°C to 55°operating -40°C to 80° storage.

**Relative humidity:** 95% non-condensing at 40°C.

**Vibration Survival:** Random 5-20 Hz 0.05 g<sup>2</sup>/Hz, 20-150 Hz -3dB/Oct. (1.7g rms).

**Shock:** Half sine, 20g/11ms.

**System List:**

**TT-3007A Antenna:** Directional RHCP Patch Array with +/- 15 deg. beam width.

**G/T:** -17 dB/K minimum.

**EIRP:** 11-17 dBW in 2 dB steps.

**Antenna Cable:** SMB/SMB male, max. cable loss 10 dB at L-Band, 0.7( at DC.

**TT-3007A Antenna and TT-3034A**

**Transceiver Dimensions:** H x W x D, 52mm x 270mm x 200mm. Weight: 2.2 kg (incl. handset, battery pack and antenna).

**TT-3007E High Gain Antenna:** Flat panel patch RHCP antenna. Manually adjustable elevation setting. Beam-width approx. 20°.

**G/T:** Min. -7 dB/K. EIRP: 8-14 dBW in 2 dB steps.

**Antenna Cable:** TNC-TNC, max. cable loss 10 dB at L-Band, 1.8( at DC.

**TT-3007E High Gain Antenna Dimensions:** H x W x D, 568mm x 570 mm x 558mm. Weight: 4 kg.

■ Our products are under continuous research and development. This information may therefore change without prior notice. Capsat is a registered trademark of Thrane & Thrane A/S, Denmark.

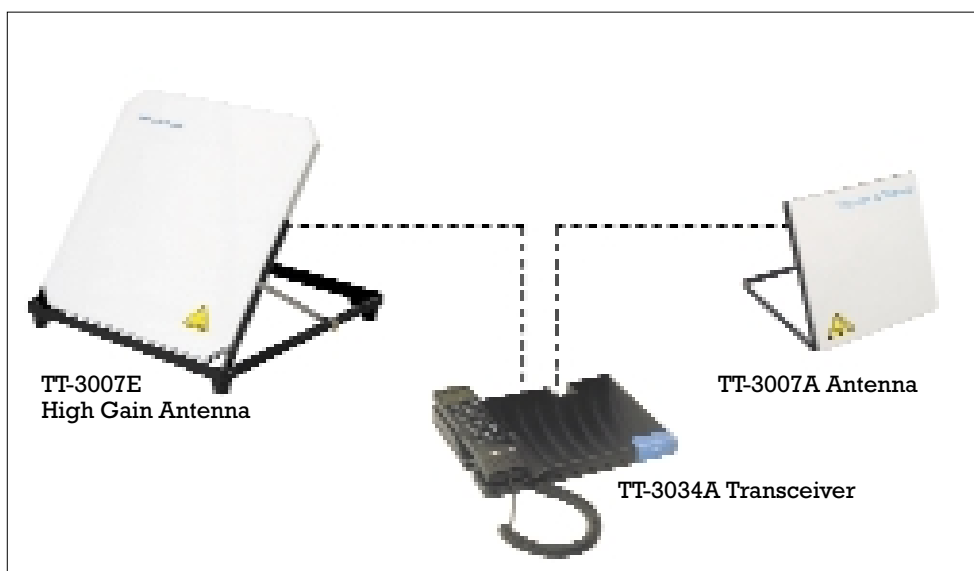

Distributor: